

TILLAMOOK COUNTY SURVEYORS OFFICE
COURTHOUSE, TILLAMOOK, OREGON 97141

INITIAL POINT GREEN ACRES 2ND ADDITION
SECTION 27 T.1S., R.9W., W.M.

INI PT
GREEN ACRES
+
2ND ADD
LS 793
2001

I FOUND A 2" IRON PIPE WITH A WOOD PLUG AND TACK,
6" DEEP, ON THE EAST EDGE OF A GRAVEL PARKING AREA,
ORIGINAL MONUMENT, (SEE T.C.S. MAP #C-326).
I SET A 5/8" IRON ROD WITH A 3" TILLAMOOK COUNTY
SURVEYORS BRASS CAP INSIDE THE FOUND 2" IRON PIPE
AND ENCASED IN AN IRREGULAR MASS OF CONCRETE.

NEW ACCESSORY

POWER POLE #274804 N.42°E. 2.88' TO A NAIL WITH BRASS T.C.S. WASHER IN THE
SIDE CENTER OF THE POLE.

HISTORY OF FOUND MONUMENT

I FOUND THIS MONUMENT TO BE AS DESCRIBED IN SAID T.C.S. MAP #C-389
AND MAP A-5590.

LOCATION OF MONUMENT

THIS INITIAL POINT IS LOCATED ON THE SOUTH SIDE OF FAIRVIEW COUNTY
ROAD, APPROXIMATELY 30' SOUTH OF THE CENTERLINE.

IN THE PRESENCE OF DAN MCNUTT & AL DVORAK

FEBRUARY 15, 2001

TITLE:

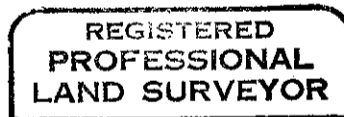

Allan E. Duncan C.S.

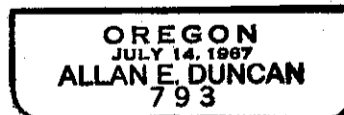

RENEWAL 12-31-01